

April 6 - May 5 , 2021



2020 Spring Program



In NAGANO JAPAN



Period・Participation Fee

2weeks

April 6 (Tue)
▽
April 20 (Tue)

128,000円~

4weeks

April 6 (Tue)
▽
May 5 (Wed)

185,000円~



MANABI

JAPANESE LANGUAGE INSTITUTES
NAGANO Campus

NAGANO TOKYO



Accommodation and Participation Fee

Ueda Daiichi Hotel



5-mins walk to school
w/o meals
Located at the heart of the city
Very convenient



Single

2 Weeks

166,000 JPY

4 Weeks

207,000 JPY

Ueda Park Hotel



18-mins to school on foot
w/o meals
There is a kitchen for cooking.
The room will be Japanese or
western.



Single

2 Weeks

128,000 JPY

4 Weeks

185,000 JPY

SAI NO TSUNO

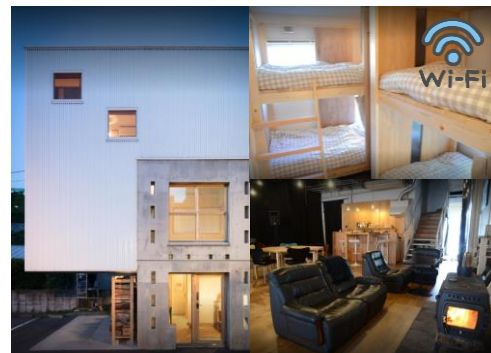

5-min to school on foot
w/o meals
shared house from 2 to 4 people



Shared

2 Weeks

128,000 JPY

4 Weeks

202,000 JPY

		4 Weeks	2Weeks
6-Apr	Tue	Entry	
7-Apr	Wed	Entrance ceremony, Placement test	
8-Apr	Thu	Orientation	
9-Apr	Fri	Class	
10-Apr	Sat	Free day	
11-Apr	Sun	Free day	
12-Apr	Mon	Cherry blossom viewing	
13-Apr	Tue	Class	
14-Apr	Wed	Class + Strawberry picking	
15-Apr	Thu	Class	
16-Apr	Fri	Class + Tea Ceremony	
17-Apr	Sat	Free day	
18-Apr	Sun	Free day	
19-Apr	Mon	Class	Class + Completion Ceremony
20-Apr	Tue	Calligraphy + Class	Departure
21-Apr	Wed	Class	
22-Apr	Thu	Class + Soba making	
23-Apr	Fri	Class	
24-Apr	Sat	Free day	
25-Apr	Sun	Free day	
26-Apr	Mon	Class + Zazen Meditation	
27-Apr	Tue	Class	
28-Apr	Wed	Class	
29-Apr	Thu	Ueda Sanada Festival	
30-Apr	Fri	Class + Completion Ceremony + Party	
1-May	Sat	Free day	
2-May	Sun	Free day	
3-May	Mon	Free day	
4-May	Tue	Free day	
5-May	Wed	Departure	

• This program will be implemented by three or more participants.

• Above amount includes taxes.

• Participation fee includes tuition, activity, airport – transfer fee (From the airport to Ueda city), accommodation fee and insurance while staying here in Japan.

• Airfare, class material fees and transportation expenses from Ueda city to the airport are not included.

• Please apply for SAI NO TSUNO by pair.

• Depending on the circumstances of the hotel, we may not be able to prepare the hotel, room you preferred.

• You can study in a class according to your level. Also, depending on your level you will be placed in the AM(8:40-12:20) class or PM(13:10-16:50) class.

• Schedule may be subjected to change.

Application Deadline: January 29, 2021



MANABI 外語学院

MANABI Japanese Language Institute

長野校 NAGANO Campus

tel : +81-268-28-7788

mail : nagano@manabi.co.jp

URL : www.manabi.co.jp



“manabinagano”



〒386-0024 長野県上田市大手2-3-1 YCCビル

2-3-1 YCC Bldg, Ote, Ueda-Shi, Nagano, Japan, 386-0024